

123.045

Aliante

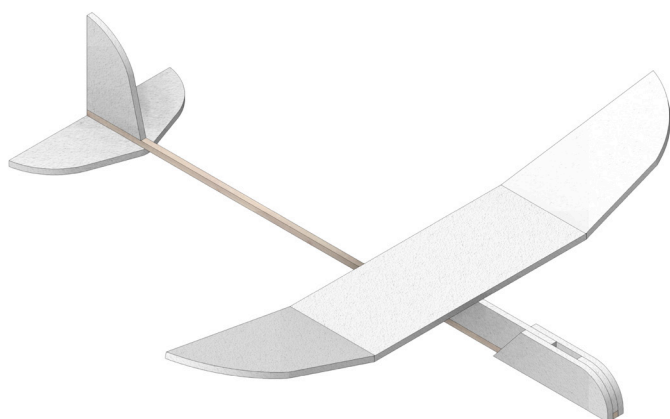

Utensili necessari:

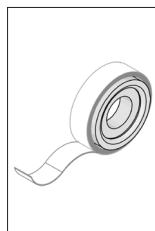

Nastro adesivo

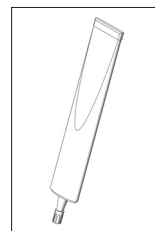

Colla universale

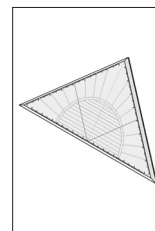

Goniometro

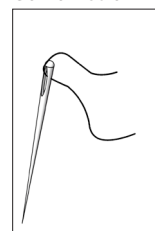

Ago

Avvertenzal:

Kit della OPITEC non sono oggetti a carattere ludico che normalmente si trovano in commercio, ma sussidi didattici atti a sostenere l'insegnamento e l'apprendimento. Questi kit possono essere costruiti ed utilizzati da bambini e ragazzi solo sotto la guida e la supervisione di adulti esperti. Non adatto per bambini sotto i 36 mesi. Pericolo di soffocamento!

Componenti	Quantità	Dimensioni (mm)	Denominazione	N di parte
Espanso rigido perforato	1	410x114x3	singole parti	1
Listello di legno	1	310x3x3	vettore	2
Sfere di metallo	20		Pesi	3
Carta vetrata	1		lavorazione bordi	4

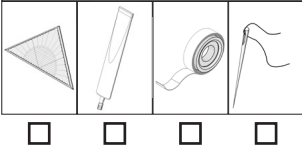
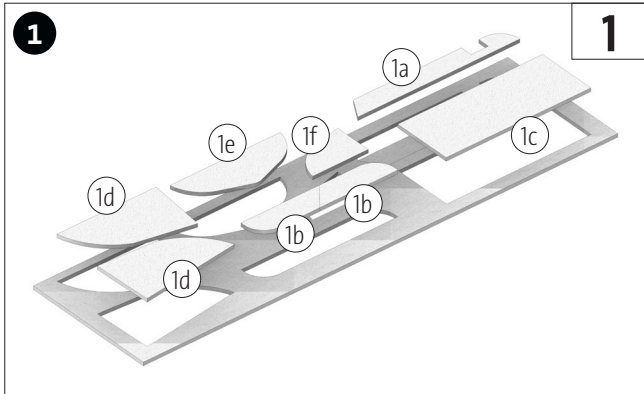

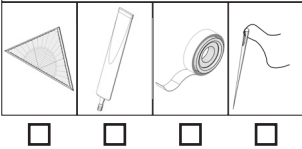
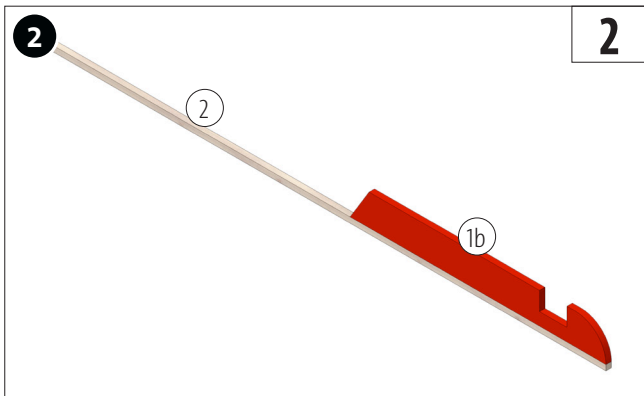

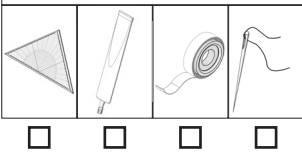
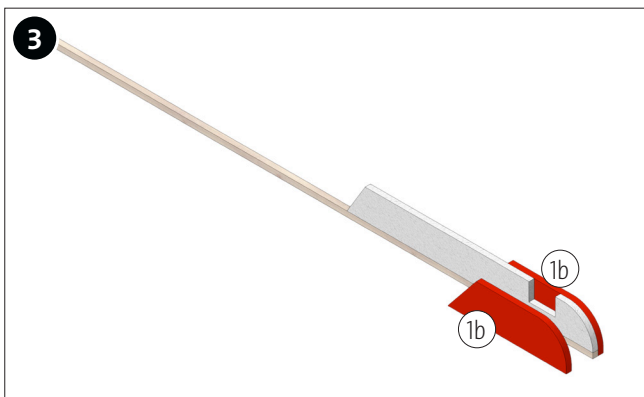

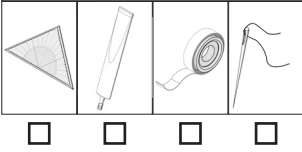
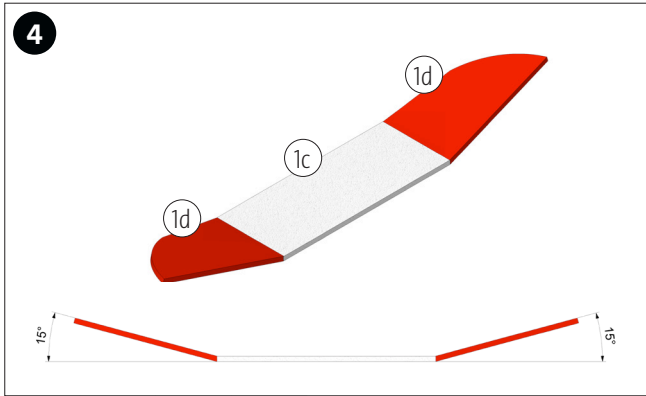

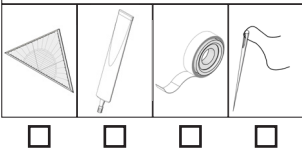
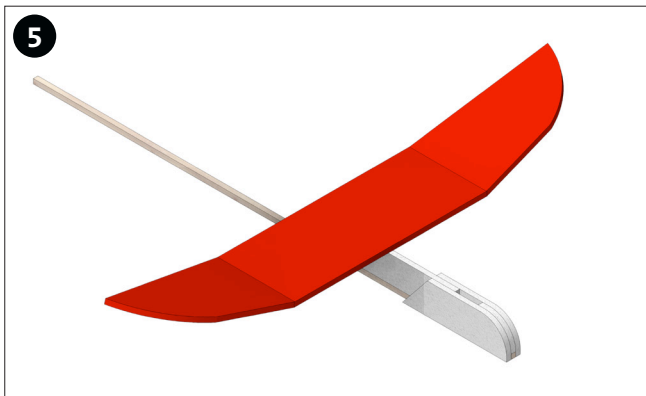

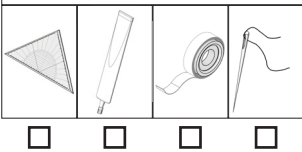
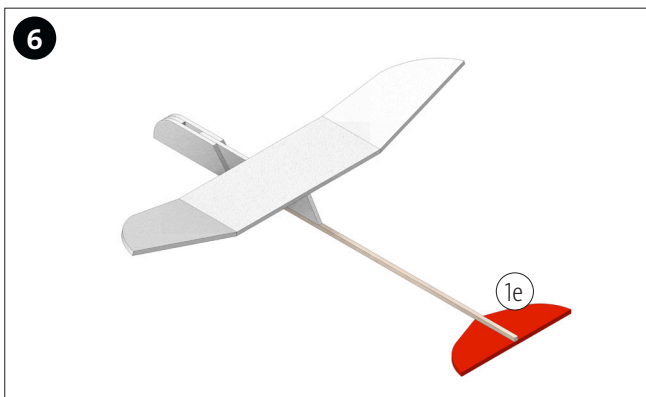

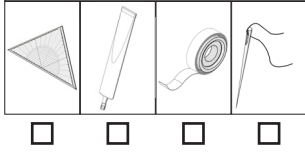
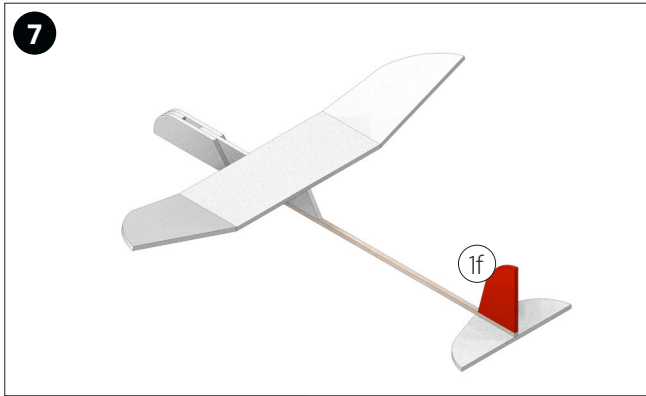

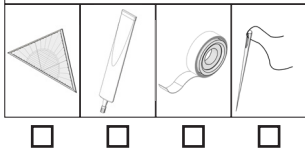
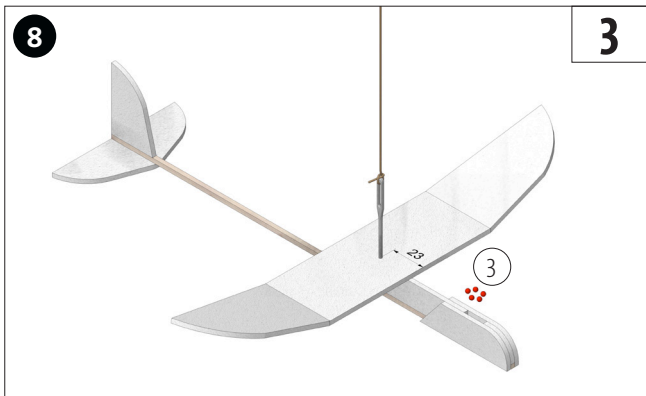

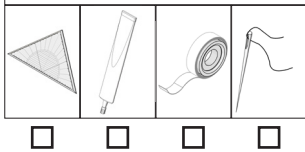
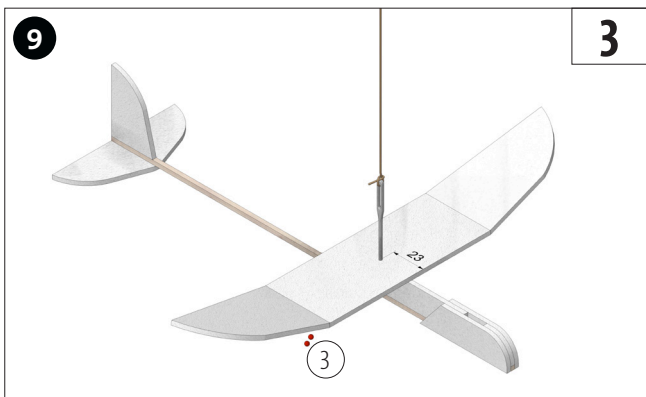

10

